

PREPRINTED BACKGROUNDS INSTRUCTIONS

Support Hotline 805-579-1111

Thank you for purchasing Dirt Digits preprinted backgrounds, we hope you enjoy your product and continue to be our valued customer for years to come. Please feel free to call Dirt Digits if you have any questions, or problems with your backgrounds or installation.

Preparation

Used Plastic Cleaning

Thoroughly clean the front and back sides of the plate of dirt, and adhesive. You may need to use a solvent such as brake cleaner, lacquer thinner, or lighter fluid to remove the adhesive from previous backgrounds.

New Plastic Cleaning

Clean about a one inch border around the outer edges of the plastic mounting surfaces with a towel dampened with a solvent such as brake cleaner, lacquer thinner, or lighter fluid. This will insure good adhesion around the perimeter, but will also be easier to clean upon removal.

Application Instructions

TIP: For beginners start with the front plate, leaving the pipe side plate for last.

1. Mock fit the backgrounds for a general idea of alignment.
2. Thoroughly wet the number plate with Windex® or Sticker-On®. Note: Use Soapy water for longer working time (2 drops/16oz.)
3. Lightly warm the background with a hairdryer to soften the material.
4. Remove the liner paper from the decal and save it to the side.
5. Align the background to the plate, first with the inner holes and plate tips, and then the outer edges. **See Figure 1**
6. Firmly tack down the background along the center ridge/line of the plate about two inches wide using a wet thumb or finger. **See Figure 2 (No.1)**
7. Heat the background with a hairdryer until the background begins to conform to the plate.
8. Place the backing liner over the background (smooth side up) and using the supplied stiff squeegee, firmly press from the center of the plate to the outer edge in one stroke. Overlap each stroke. **See Figure 2**
9. If you find bubbles or creases, first cool the graphic and then lift the graphic back beyond the area. Then heat it with a hairdryer before laying it back down. Use a wet thumb to press it back down being careful not to over stretch the material.

TIPS:

- Proper alignment is key. If you start off misaligned it will be harder to fit in contoured areas later. Take your time, and keep the plate wet until you are satisfied with the initial alignment.
- When the material begins to bunch in an area, divide the bunch into smaller bunches with your thumbs, and work them closer to edge as you go. Then heat the area and flatten them to the edge with the squeegee. **See Figure 3**
- Use a hair dryer to dry any edges where the Windex® (or soap) is preventing the decal from sticking. Allow several hours to pass before riding.
- To bring back a high-gloss luster, use a hair dryer on high heat over the entire background, being careful not to stop too long.

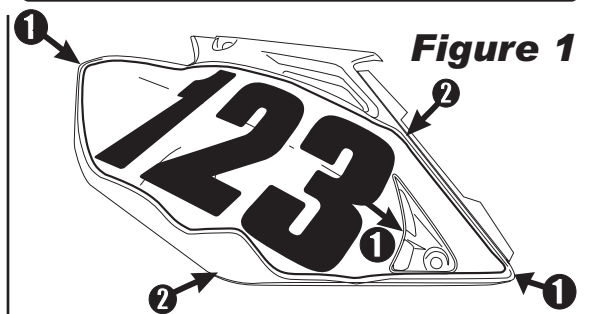

Figure 1

Align inner holes & plate tips, and then check for any hanging edges.

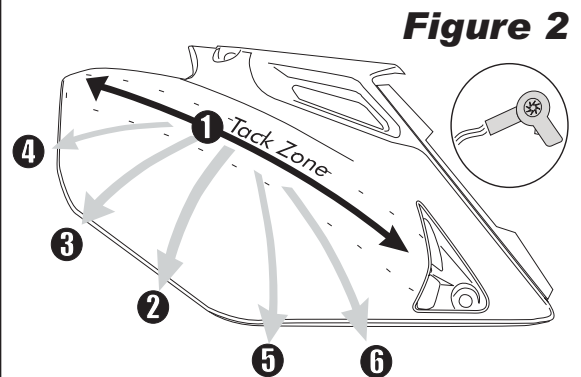

Figure 2

Use firm strokes in this pattern, overlapping as you go. Use light heat to make the background more pliable.

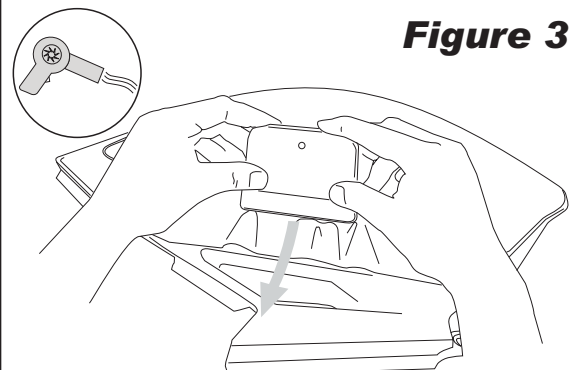

Figure 3

Use light heat to soften material and push any bunched material flat. If you cause a crease, peel the background back and reheat.

made with
**PROFORMX
PX23**